

**FOR INFORMATION ONLY  
NOT FOR CONSTRUCTION**

**NOTES:**

- This detail is for pedestrian traffic only, not suitable for driveways.
- Comply with all relevant Australian Standards.
- Refer to relevant Town Centre Streetscape Master Plan and Technical Guidelines for paver selections and performance criteria.
- Refer to relevant Town Centre Streetscape Master Plan and Technical Guidelines for concrete finishes and performance criteria.

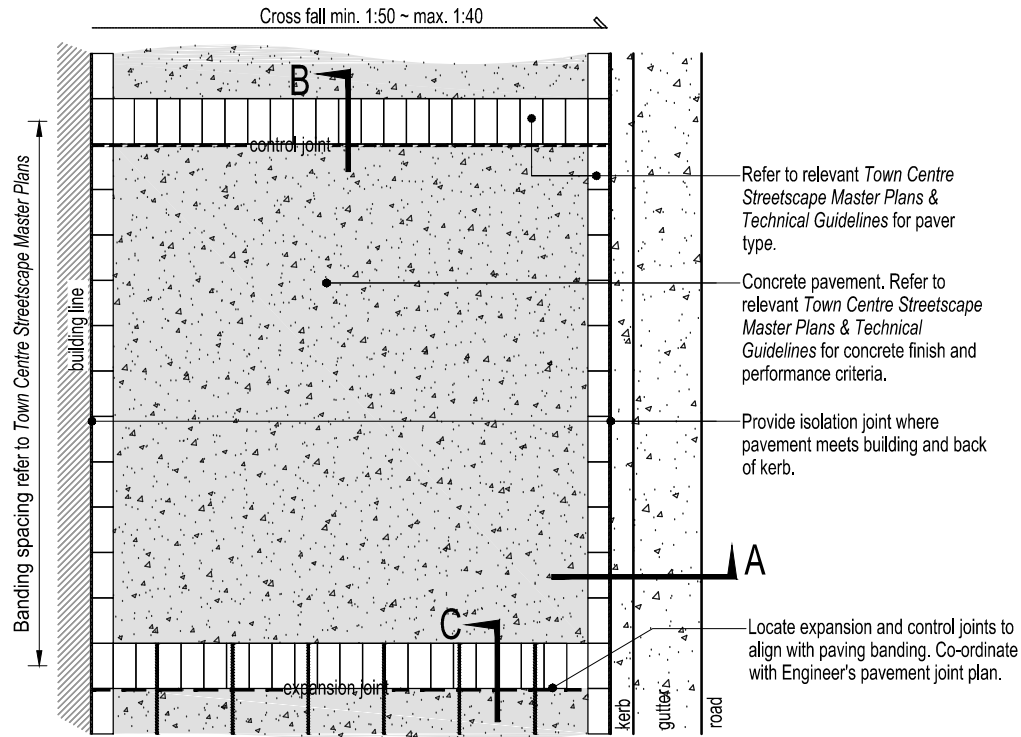

**1 Concrete footpath with Pavers**  
Typical plan scale 1:50

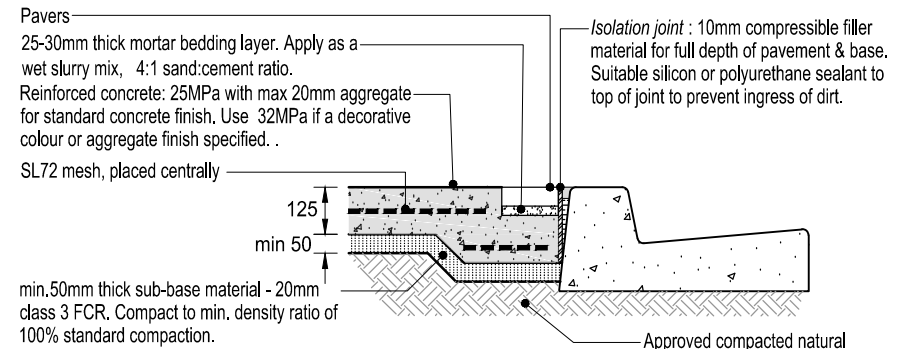

**1 ISOLATION JOINT**  
Section A Scale 1:20

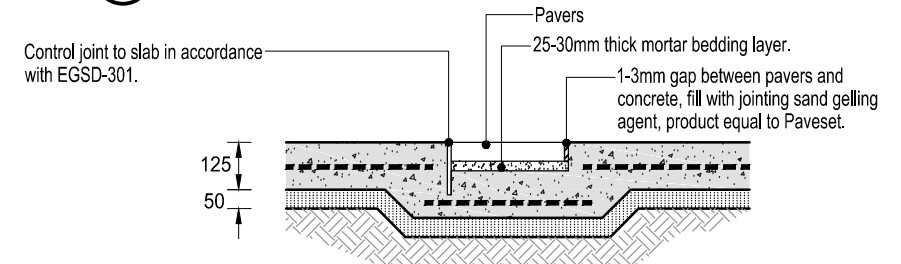

**2 CONTROL JOINT**  
Section B Scale 1:20

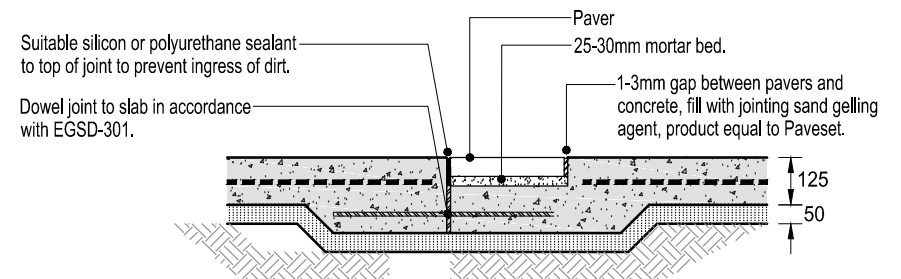

**3 EXPANSION JOINT**  
Section C Scale 1:20

WORK TO FIGURED DIMENSIONS – DO NOT SCALE. DO NOT RELY ON THESE STANDARD DRAWINGS AS THE EQUIVALENT OF, OR SUBSTITUTE FOR, PROJECT-SPECIFIC DESIGN & ASSESSMENT BY A QUALIFIED PROFESSIONAL.



126-138 MAIN ROAD  
SPEERS POINT  
PHONE (02)4921 0333  
[www.lakemac.com.au](http://www.lakemac.com.au)  
SHEET: 1 OF 1

DRAWING TITLE Standard Drawings - Pavement  
**Concrete footpaths with Pavers**  
DRAWING No: LSD-PAV-02  
VERSION: 2

VERSION	DATE	COMMENTS	PAPER SIZE
2	2015-11	Amended format, Review 2015.	A4
1	2013-05	Final for DCP.	A4