

FOR INFORMATION ONLY  
NOT FOR CONSTRUCTION

- H4 treated timber pegs:
- nom. 50mm square pegs x 450mm long, sharpened at one end and driven into firm ground;
  - generally place pegs on the mass planting side at 1200mm centres, at changes in direction & at each end of timber edge boards;
  - finish 25mm below edge boards. Drive in on planting side of edging.

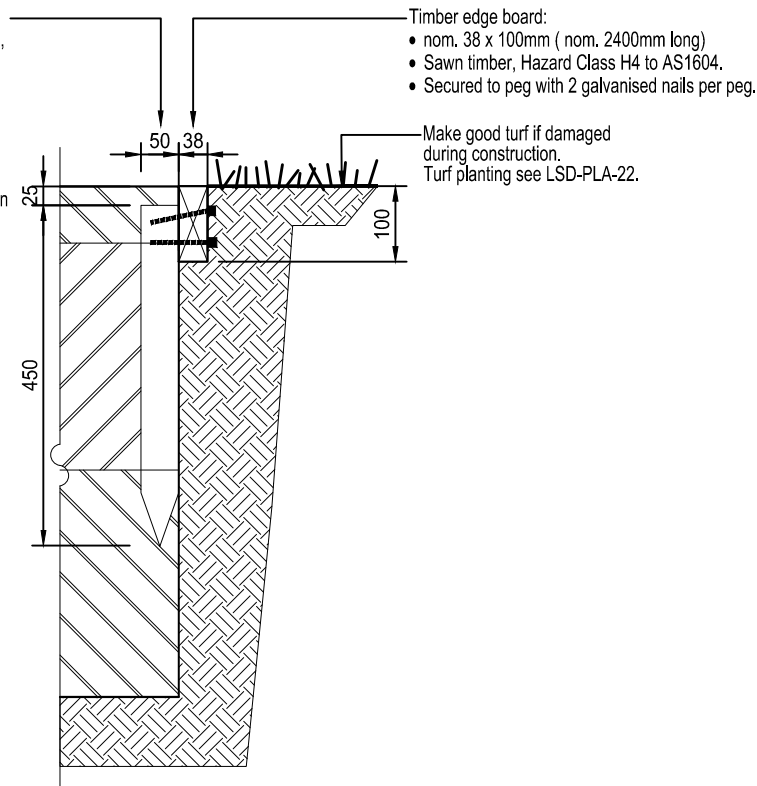

**D1** Typical Timber Edge  
Typical Section scale 1:10

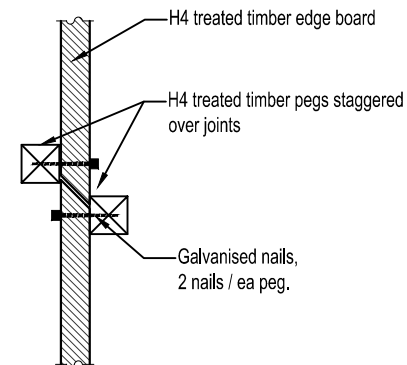

**D2** Straight Timber Edging Joint  
Typical plan scale 1:10

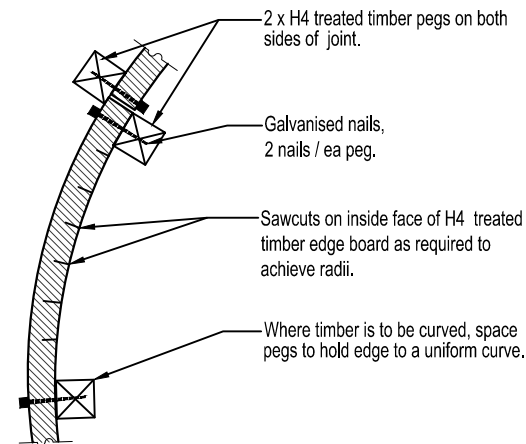

**D3** Curved Timber Edging Joint  
Typical plan scale 1:10

WORK TO FIGURED DIMENSIONS – DO NOT SCALE. DO NOT RELY ON THESE STANDARD DRAWINGS AS THE EQUIVALENT OF, OR SUBSTITUTE FOR, PROJECT-SPECIFIC DESIGN & ASSESSMENT BY A QUALIFIED PROFESSIONAL.



126-138 MAIN ROAD  
SPEERS POINT  
PHONE (02)4921 0333  
[www.lakemac.com.au](http://www.lakemac.com.au)

SHEET: 1 OF 1

DRAWING TITLE  
Standard Drawings - Edging  
**Timber Edging (typical)**

DRAWING No: LSD-EDG-01

VERSION:

2

VERSION	DATE	COMMENTS	PAPER SIZE
2	2015-11	Amended format, Review 2015.	A4
1	2013-05	Final for DCP.	A4